

## ADDENDUM NO. 3

1.11.2019

CLIENT NAME

# EMBRACE PARK RESTROOMS

NORFOLK, NE

**BID DATE IS January 17<sup>th</sup>, 2019 AT 2:00 PM**

The original Project Manual and Drawings for the project noted above are amended as noted in this Addendum. Included in this Addendum are Specification, Architectural, & Engineering items.

Please review all sheets and incorporate them into your set of Contract Documents.

The receipt of this Addendum shall be acknowledged by inserting its number and date in the space provided on the Bid Form.

---

### SPECIFICATIONS

#### SECTION – 01 0400-3 SPECIAL CONDITIONS

- A. DELETE - 1.11 CONSTRUCTION SIGN.

### DRAWINGS

#### SHEET C1 – EMBRACE PARK RESTROOM SITE PLAN

- A. SEE ENCLOSED SITE DRAWING (C1) FOR ADDITIONAL CIVIL INFORMATION.

#### SHEET A1.01 - ARCHITECTURAL NOTES

- A, DELETE JOB SIGNS FOR THIS PROJECT.

**END OF ARCHITECTURAL ADDENDUM**

# Addendum 3: Embrace Park Restroom Site Plan

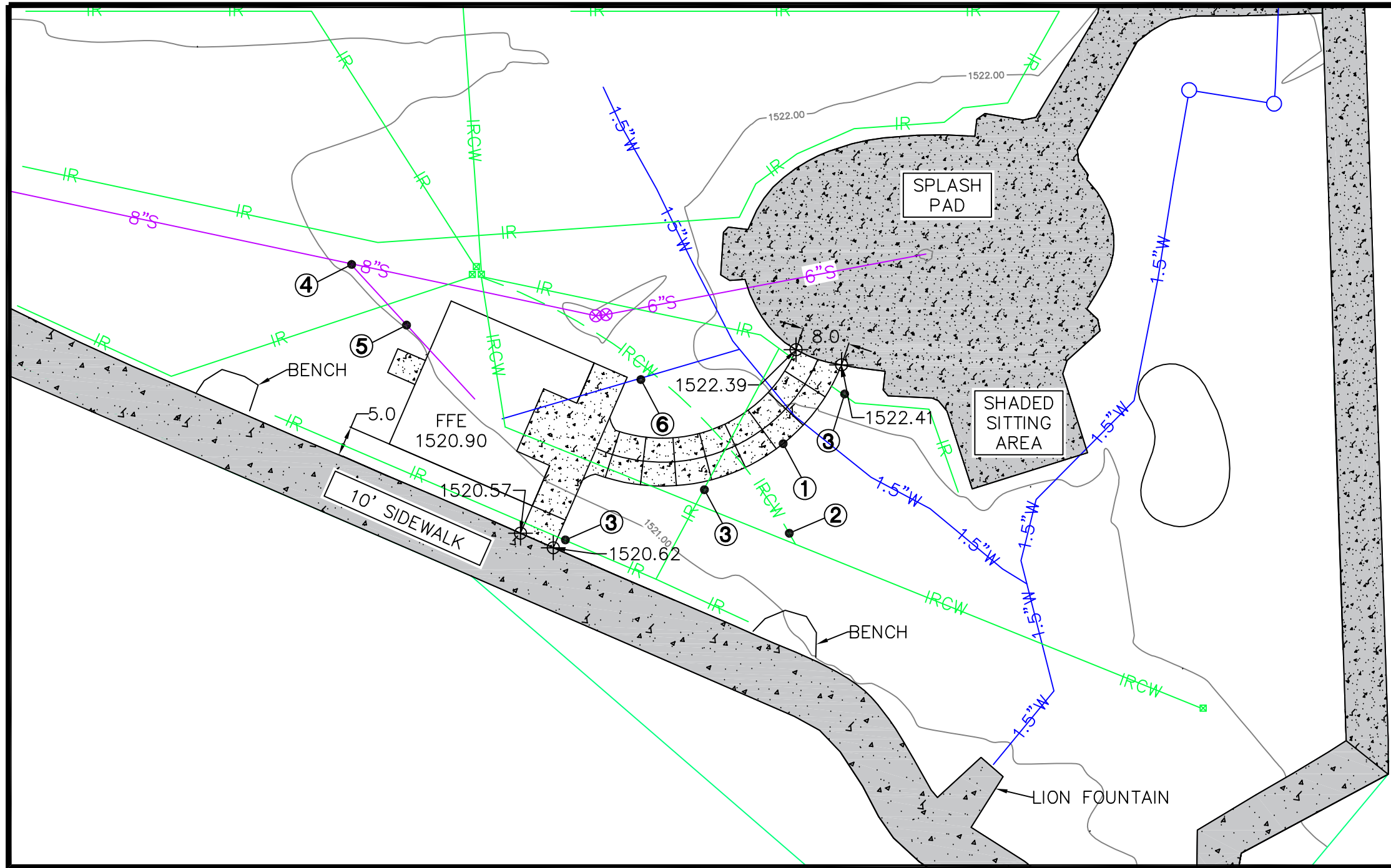

## Additional Quantities:

INSTALL 4' SIDEWALK		
LOCATION	QTY	UNIT
①	44	SY

INSTALL 8'X4' SANITARY SEWER WYE		
LOCATION	QTY	UNIT
④	1	EA

EXPOSE AND RELOCATE IRRIGATION CONTROL WIRE		
LOCATION	QTY	UNIT
②	85	LF

INSTALL 4' SANITARY SEWER SERVICE		
LOCATION	QTY	UNIT
⑤	31	LF

EXPOSE AND LOWER IRRIGATION LINE		
LOCATION	QTY	UNIT
③	27	LF

INSTALL 1.5' WATER SERVICE		
LOCATION	QTY	UNIT
⑥	42	LF

## Legend:

- ☒ Irrigation Control Box
- ⊗ Sewer Cleanout
- 8"S— 8" Sanitary Sewer Line
- 6"S— 6" Sanitary Sewer Line
- 1.5"W— 1.5" Water Line
- IR— Irrigation Line
- IRCW— Irrigation Control Wire
- ⊕ Existing Elevation

### General Notes:

- Locations of underground irrigation lines are approximate. Contractor to locate irrigation lines prior to construction of building.
- Sidewalks shall be constructed with a maximum slope of less than 2%.
- Contractor shall slope grade away from restroom at 10:1 slope for a minimum of five (5) feet and then grade to tie in to existing ground at 10:1 unless steeper slope is approved by City Engineer.
- Contractor to fine grade site upon completion of construction in preparation of seeding.

